



P&H METAL PRODUCTS CORP.
BUYERS CHOICE FOR CUSTOM & INDUSTRY
STANDARD PRODUCTS SINCE 1969

28625 BRAXTON AVE • VALENCIA, CA 91355
PHONE: (661) 257-3977 | FAX (661) 257-0457
EMAIL: SALES@PHMETAL.COM | WEB WWW.PHMETAL.COM



HISTORY

P&H Metal Products has been supplying hardware of all kinds to Manufacturers since 1969. We have successfully built a loyal base of customers through our competitive pricing, dependable delivery and exceptional customer service. In keeping with the changing times, P&H Metal is constantly evaluating and updating our technology in an effort to serve you more efficiently, accurately and quickly.

CONTENTS

PLASTICS.....	5,6
WIRE FORMS.....	7,8
SNAP HOOKS.....	9,10
CARGO RESTRAINT.....	11,12
TENT HARDWARE.....	13,14
BUCKLES.....	15,16
STAMPINGS & BELT CLIPS.....	17,18
RIVETS.....	19
WEBBING.....	20
HOOK & LOOP.....	21,22
CUTTING MACHINES.....	23-25

Note: If you don't see the item you are looking for, it doesn't mean we don't have it! Call us and we will be happy to see if we can source it for you.

TERMS & CONDITIONS

PRICE LIST

DUE TO THE VAST VARIETY OF OUR MERCHANDISE, WE DO NOT PUBLISH A PRICE LIST. PRICES WILL BE GIVEN UPON REQUEST FOR SPECIFIC ITEMS OF INTEREST.

TERMS

ALL SHIPMENTS WILL BE MADE ON OPEN ACCOUNT IF A SATISFACTORY CREDIT RATING HAS BEEN ESTABLISHED. OTHERWISE, SHIPMENTS CAN BE MADE ON A C.O.D. OR PREPAID BASIS. ANY RETURNED CHECKS WILL RESULT IN A \$20.00 SERVICE FEE.

PLACING OF ORDERS

ALL PHONE ORDERS WILL BE CONFIRMED IN WRITING. PLEASE STATE "CONFIRMATION ONLY." \$50.00 MINIMUM ORDER. ALL PRICES SUBJECT TO CHANGE WITHOUT NOTICE UPON COMPLETION OF CURRENT ORDERS. A \$15.00 SURCHARGE WILL BE ADDED TO INVOICE IF UNDER \$50.00.

OUTGOING SHIPMENTS

ALL SHIPMENTS LEAVING OUR WAREHOUSE ARE SHIPPED IN A SAFE AND SECURE MANNER, AND WE ARE NOT RESPONSIBLE FOR DAMAGES EN ROUTE CAUSED BY ANY MISHANDLING OF THE PRODUCT. ANY CLAIMS FOR LOSSES MUST BE MADE WITH THE CARRIER. PLEASE NOTE ANY LOSSES OR DAMAGES ON YOUR BILL OF LADING AT THE TIME OF DELIVERY. BALANCE OF GOODS WILL BE SHIPPED ON PREVIOUSLY AGREED UPON DATES WITHOUT PRIOR NOTIFICATION.

ALL CONTRACTS ARE CONSIDERED COMPLETE IF DELIVERY IS MADE OF AT LEAST 90% OF THE SPECIFIED QUANTITY BUT NO MORE THAN 110% OF THE SPECIFIED QUANTITY

RETURNED GOODS

NO GOODS WILL BE RETURNED WITHOUT PRIOR AUTHORIZATION. UNAUTHORIZED RETURNED GOODS WILL BE REFUSED AND SENT BACK AT CUSTOMER'S EXPENSE. THERE WILL BE A 20% RESTOCKING CHARGE FOR RETURNED GOODS THAT WERE ORDERED IN ERROR BY THE CUSTOMER. RETURNED GOODS MUST BE IN GOOD CONDITION AND NOT DAMAGED IN ANY WAY. CLAIMS FOR RETURNED GOODS MUST BE MADE WITHIN 10 WORKING DAYS OF RECEIVING SHIPMENT.

CREDITS

CREDITS WILL BE ISSUED FOR RETURNED, EXCHANGED, OR DAMAGED GOODS. THESE CREDITS MUST BE APPLIED AGAINST FUTURE ORDERS. NO CASH REFUNDS WILL BE ISSUED.

SPECIAL CONTRACTS

ALL SPECIAL CONTRACTS CAN NOT BE CANCELLED.

ALL CONTRACTS FOR OTHER THAN STANDARD ITEMS ARE CONSIDERED COMPLETE IF DELIVERY IS MADE OF AT LEAST 90% OF THE SPECIFIED QUANTITY BUT NO MORE THAN 110% OF THE SPECIFIED QUANTITY.

DISCLAIMER:

"THERE IS NO WARRANTY, REPRESENTATION OR CONDITION OF ANY KIND, EXPRESSED OR IMPLIED, (INCLUDING NO WARRANTY OF MERCHANTABILITY OR OF FITNESS), AND NONE SHALL BE IMPLIED BY LAW. FINAL DETERMINATION OF THE SUITABILITY OF THE MATERIAL FOR THE USE CONTEMPLATED BY THE BUYER IS THE SOLE RESPONSIBILITY OF THE BUYER, AND SELLER SHALL HAVE NO RESPONSIBILITY IN CONNECTION WITH SUCH SUITABILITY, SELLER DOES NOT ASSUME RESPONSIBILITY FOR DEFECTS, INJURIES, OR DAMAGES CAUSED BY MISUSE, ALTERATION, ABUSE, OR UNSUITABILITY AS TO APPLICATIONS OR LOAD BEARING STRENGTHS. BUYER IS RESPONSIBLE FOR DETERMINING THE APPROPRIATE APPLICATION AND TOLERANCE OF THE GOODS SOLD HEREIN."



PLASTICS

Everything from Buckles to Slides to Custom moldings.



P153

2" LONG SIDE RELEASE BUCKLE,
CONTOURED, ACETAL

SIZES: 1/2", 5/8", 3/4", 1"



JO6B

SIDE RELEASE BUCKLE,
DOUBLE ADJUST, ACETAL

SIZES: 3/4", 1", 1 1/2", 2"



JO6A

SIDE RELEASE BUCKLE, ACETAL

SIZE: 3/4", 1", 1 1/2", 2"



SR

SIDE RELEASE BUCKLE,
ACETAL

SIZE:
3/4", 1", 1 1/4", 1 1/2", 2"



P153A

1-7/8" LONG SIDE RELEASE
BUCKLE, CONTOURED, ACETAL

SIZES: 7/16", 5/8", 3/4", 1"



SHK
 PLASTIC SNAP HOOK, ACETAL
 SIZES: 3/4", 1", 1 1/4", 1 1/2", 1 3/4", 2"



SHKU
 SWIVEL SNAP HOOK, ACETAL
 SIZES: 1", 1 1/2", 2"



SVHK
 SNAP HOOK, ACETAL
 SIZES: 3/4", 1", 1 1/4", 1 1/2", 1 3/4", 2"



CND
 CENTER NOTCH D RING, ACETAL
 SIZES: 3/4", 1", 1 1/4", 1 1/2", 2"



HD
 HEAVY DUTY D RING, ACETAL
 SIZES: 1", 1 1/2", 2"



RD
 D RING, ACETAL
 SIZES: 3/4", 1", 1 1/4", 1 1/2", 2"



LL
 LADDER LOCK, ACETAL
 SIZES: 1/2", 5/8", 3/4", 1", 1 1/4"



P136
 LADDER LOCK, HEAVY DUTY ACETAL
 SIZES: 1", 1 1/2", 2"



CTBS
 TRI GLIDE, ACETAL
 SIZES: 1", 1 1/4", 1 1/2", 2"



TBS
 TRI GLIDE, WIDE MOUTH, ACETAL
 SIZES: 1", 1 1/2", 2"



CRL
 LOOP, ACETAL
 SIZES: 1", 1 1/2", 2"



SPN
 SHOULDER PAD
 SIZES: 1", 1 1/2", 2"



P020A
 SHOULDER PAD
 SIZES: 1", 1 1/2", 2"



X007A-5
 HANDLE, WITH WEBBING
 SIZES: 15" OVERALL LENGTH

PLEASE SEE WEBSITE FOR MORE STYLES



X012
 HANDLE, WITH WEBBING
 SIZES: 14 1/2"
 16"
 18" OVERALL LENGTH



P048
 GRIP BUCKLE, ACETAL
 COLOR: BLACK



TR
 TRIANGLE
 SIZES: 1", 1 1/2"



K183D
 CELL PHONE CLIP



K183E
 RATCHETING CELL PHONE CLIP



6819BLK
 PAD EYE
 MATERIAL: ACETAL



WIRE FORMS

O Rings, D Rings, Loops, Slides, & Customs



1954N
D RING WITH CLIP
SIZE: 5/8", 3/4", 1"



1954SS
STAINLESS STEEL D
RING WITH CLIP
SIZE: 5/8", 3/4", 1"



2535N-WLD
1" X 7/8" D RING .175
WIRE, WELDED
FINISH: NICKEL PLATE



3250SS-1-WLD
1" D RING, .1969" WIRE,
WELDED, STAINLESS STEEL
FINISH: NICKEL PLATE
SIZE: 1" X 1"



3250SS

D RING, .236" WIRE,
WELDED, STAINLESS STEEL

FINISH: NICKEL PLATE

SIZE:
1 1/2" X 1 1/4"
2 X 1 3/4"



3250N-1-WLD

1" X 7/8" D RING, .1969" WIRE,
WELDED

FINISH: NICKEL PLATE



3250N-1.5-WLD

1.5" D RING, .236" WIRE,
WELDED

FINISH: NICKEL PLATE



3250N-2-WLD

2" D RING, .236" WIRE, WELDED

FINISH: NICKEL PLATE



2467

O RING, .177" WIRE, WELDED
FINISH: NICKEL PLATE

SIZE: 1", 1 1/4"



4N

O RING, .235" WIRE,
WELDED

FINISH: NICKEL PLATE

SIZE: 1 1/2", 2"



2715Z

2" O RING, .190" WIRE,
WELDED

FINISH: WHITE ZINC



2985WHI-Z

2" O RING, .37" WIRE, WELDED

FINISH: WHITE ZINC



3N

O RING, .243" WIRE WELDED
FINISH: NICKEL PLATE



2467SS-WLD

1" O RING, .177" STAINLESS
WIRE ARGON WELDED



2988SS

1 1/2" O RING, .229"
304 STAINLESS WIRE WELDED



2468

WIRE LOOP, WELDED
FINISH: NICKEL PLATE

SIZES:
3/4" X 3/8" W/.105" WIRE
1" X 7/16" W/.105" WIRE
1 1/2" X 1/2" W/.120" WIRE
2" X 9/16" W/.135" WIRE



SNAP HOOKS

Die Cast to Stamped to Solid Brass



9001N-Z
2 3/8" LONG SNAP HOOK,
ZINC DIE CAST

SIZES: 3/4", 1", 1 1/2", 2"



3726
SNAP HOOK, ZINC DIE CAST

SIZES:
3/4" X 2 1/2"
1" X 2 1/2"



25N-Z
RIGID EYE SNAP HOOK,
ZINC DIE CAST

SIZES:
3/4" X 3 3/8"
1" X 3 3/8"



017N-Z
SNAP HOOK, ZINC DIE CAST

SIZES:
5/8" X 3 1/4"
3/4" X 3 3/4"
7/8" X 3 1/4"
1" X 3 1/4"



PH-A245
ALUMINUM CARABINER

SIZES:
40 X 4 MM
50 X 5 MM
60 X 6 MM



PH-A245
ALUMINUM CARABINER

SIZES:
40 X 4 MM
50 X 5 MM
60 X 6 MM



PH-A245
ALUMINUM CARABINER

SIZES:
40 X 4 MM
50 X 5 MM
60 X 6 MM



2094
SWIVEL SNAP HOOK, ZINC DIE
CAST

SIZES:
1" X 2 3/8"
1 1/2" X 2 3/8"
2" X 2 1/2"



5015N-Z

2 3/8" OVERALL LENGTH,
SNAP HOOK, ZINC DIE
CAST

SIZES: 5/8", 3/4", 1"



2001

SNAP HOOK, ZINC DIE CAST

SIZES: 1"



2455N-R

SNAP HOOK, ZINC DIE CAST

SIZES:
1/2" X 3 7/16"
5/8" X 3 5/8"
3/4" X 3 5/8"
7/8" X 3 7/8"
1" X 3 7/8"



161N-Z-3-1/2

3-1/2" DOUBLE END SNAP
HOOK, ZINC DIE CAST



162N-Z-4

4" DOUBLE END SNAP
HOOK, ZINC DIE CAST



163N-Z

4-5/8" DOUBLE END SNAP,
ZINC DIE CAST



3141N-M

3/4" X 3-3/4" MALLEABLE
IRON SNAP



3142N-M-7/8

7/8" X 4" BULL SNAP W/SWIVEL
NICKEL PLATE



5055PL-B

SNAP HOOK, SOLID BRASS

SIZES:
3/8" X 2 1/2"
1/2" X 2 7/16"



161PL-B-3 1/2

3-1/2" DOUBLE END SNAP
HOOK, SOLID BRASS



162PL-B-4

4" DOUBLE END SNAP
HOOK, SOLID BRASS



162PL-B-4 1/2

4 1/2" DOUBLE END SNAP
HOOK, SOLID BRASS

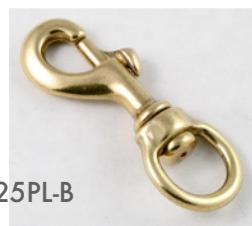

225PL-B

SNAP HOOK, SOLID BRASS

SIZES:
5/8" X 3 1/8"
3/4" X 3 1/8"
1" X 3 1/2"



017PL-B

SNAP HOOK, SOLID BRASS

SIZES:
5/8" X 2 7/8"
3/4" X 2 7/8"
1" X 3"



5350N

1 3/4" OVERALL LENGTH,
SNAP HOOK

SIZES: 1/2", 5/8", 3/4", 1"



340N-Z

1 5/8" OVERALL LENGTH,
SNAP HOOK, ZINC DIE CAST

SIZES: 1/2", 5/8", 3/4", 1"



5016-DAC-1

1" X 2-5/8" WALL HOOK

FINISH:
DICHROMATE
NICKEL PLATE



100N-1 1/8

1 1/8" SNAP HOOK

FINISH: NICKEL PLATE



2059N

2 1/8" OVERALL LENGTH, SNAP
HOOK

SIZES:
3/4", 1", 1 1/4", 1 1/2", 1 3/4", 2"



273BLK-R

1 1/2" X 2-3/4" SNAP HOOK WITH
EARS, BLACK RESIN PLATE



CARGO HARDWARE



RB101YZC
1" STANDARD RATCHET
RATING: 1,500 LB.



RB105YZC
1" RATCHET, WIDE HANDLE
RATING: 3,300 LB.



RB201YZC
2" RATCHET, WIDE HANDLE
RATING: 4,500 LB.



RB202YZC
2" RATCHET, STANDARD HANDLE
RATING: 11,000 LB.



RB203YZC
2" RATCHET, STANDARD
WIDE HANDLE
RATING: 11,000 LB.



RB204YZC
2" RATCHET, DOUBLE LOCK,
LONG WIDE HANDLE
RATING: 11,000 LB.

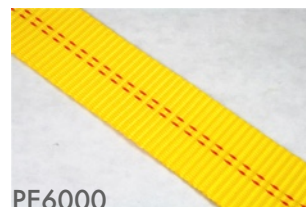

PE6000
2" POLYESTER WEBBING
RATING: 6,000 LB. TEST

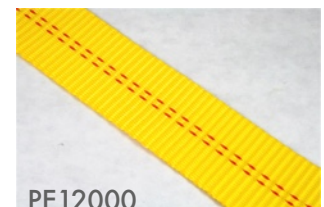

PE12000
2" POLYESTER WEBBING
RATING: 12,000 LB. TEST

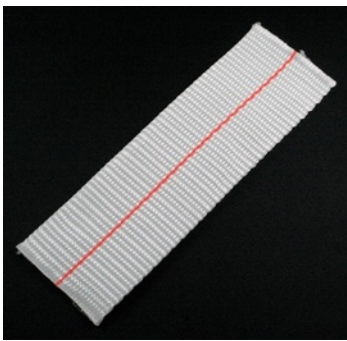

PE2-WHT-US
2" POLYESTER WEBBING
RATING: 10,000 LB. TEST



3199
2" RATCHET, 27 FT. WITH DOUBLE J HOOKS
RATING:
10,000 LB. BREAKING STRENGTH
3,335 LB. WORKING LOAD

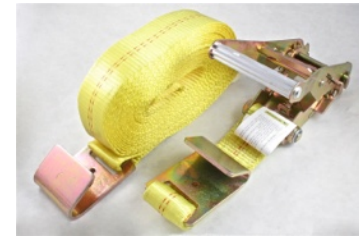

3200
2" RATCHET, 27 FT. WITH 2 FLAT HOOKS
RATING:
10,000 LB. BREAKING STRENGTH
3,335 LB. WORKING LOAD

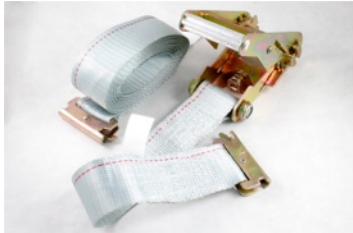

3201
2" RATCHET, 16 FT. WITH E-TRACK FITTINGS
RATING:
4,500 LB. BREAKING STRENGTH
1,500 LB. WORKING LOAD



3202
4" LASHING, 30 FT. WITH FLAT HOOK
RATING:
16,500 LB. BREAKING STRENGTH
5,500 LB. WORKING LOAD



CAM-01-1
1" CAM BUCKLE, ZINC DIE CAST, 550# TEST
FINISH: ZINC PLATE



CAM-06-1
1" CAM BUCKLE, ZINC DIE CAST, 880 # TEST
FINISH: ZINC PLATE



CAM-04-1
1" CAM BUCKLE, 1300# TEST
FINISH: ZINC PLATE



CB04
2" CAM BUCKLE, 3000 # TEST
FINISH: ZINC PLATE



CAM-03-1 1/2
2" CAM BUCKLE, 3000 # TEST
FINISH: ZINC PLATE



SH06
2" SNAP HOOK TWISTED
FINISH: WHITE ZINC PLATE
11,000 LB. TEST



TJ025481Z
3/4" TOW HOOK,
7,500LBS TEST
FINISH: ZINC PLATE



LT01
SPRING FITTING, 4500LBS
FINISH: YELLOW ZINC PLATE



DJ-5010-YCZ
2" X 9.5MM DOUBLE J HOOK
RATING: 6,600 LB.
FINISH: YELLOW ZINC PLATE



WH35301
1-1/2" DOUBLE J HOOK
RATING: 6,000 LB.
FINISH: YELLOW ZINC PLATE



WH25151
1" DOUBLE J HOOK
RATING: 3,300 LB.
FINISH: YELLOW ZINC PLATE



S-2510-YZC
9.5MM X 1" S HOOK, 1.2T CAP.
FINISH: YELLOW ZINC PLATE



JH-209
BOW SHACKLE
FINISH: ZINC PLATE
SIZE: 1/2", 3/8"



TENT HARDWARE



7350Z-7N
9/32" QUICK LINK
FINNISH: GALVANIZED



2576
CARABINER SNAP
FINNISH: GALVANIZED



BP-01-ZP
1/4" PIN X 3" LONG
FINNISH: ZINC PLATE



2974Z
1-1/8" X 1-5/16" D RING, .250 WIRE, 3000LBS TEST
FINNISH: ZINC PLATE



JH-209
BOW SHACKLE
FINNISH: ZINC PLATE
SIZE: 1/2", 3/8"

SIZE:
50MM X 5MM
60MM X 6MM
70MM X 7MM
80MM X 8MM
90MM X 9MM
100MM X 10MM
110MM X 11MM
120MM X 12MM



QP-01-3
QUICK PIN, 3" X 1 5/8" PIN
FINNISH: ZINC PLATE



PHG-411
THIMBLE
FINNISH: ZINC PLATE
SIZE:
1/8", 3/16", 1/4", 5/16", 3/8"
OTHER SIZES & HD AVAILABLE



6105
ALLIGATOR SNAP, STEEL
FINNISH:
DICHROMATE
NICKEL
BLACK
STAINLESS STEEL



7300Z
CABLE CLAMP
FINNISH: ZINC PLATE
SIZE: 1/8", 3/16", 1/4"

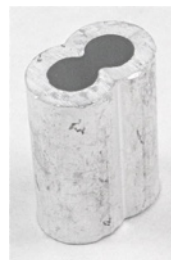

JH-DIN3093
ALUMINUM CRIMP
SIZE: 1/4", 3/16"



SH-06
2" SNAP HOOK TWISTED,
11,000 LB. TEST
FINISH: WHITE ZINC



5016

1" X 2-5/8" WALL HOOK

FINISH:
DICHROMATE
NICKEL



TJ025481Z

3/4" TOW HOOK, 7,500LBS TEST

FINISH: ZINC



S-2510-YZC

9.5MM X 1" S HOOK, 1.2T
CAP.

FINISH: YELLOW ZINC PLATE



3147

WENCH WITH PLATE

FINISH: YELLOW ZINC /
POWDER COAT



RB101YZC

1" STANDARD RATCHET

RATING: 1,500 LB.



RB105YZC

1" RATCHET, WIDE HANDLE

RATING: 3,300 LB.



RB201YZC

2" RATCHET, WIDE HANDLE

RATING: 4,500 LB.



RB202YZC

2" RATCHET, STANDARD HANDLE

RATING: 11,000 LB.



RB203YZC

2" RATCHET, STANDARD
WIDE HANDLE



RB204YZC

2" RATCHET, DOUBLE LOCK,
LONG WIDE HANDLE

RATING: 11,000 LB.



3169YZC

1" INLINE RATCHET ASSEMBLY

FINISH: YELLOW ZINC PLATE

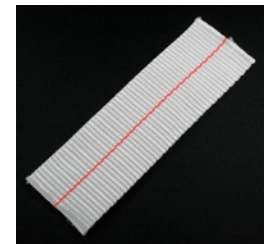

PE2-WHT-US

2" POLYESTER WEBBING

RATING: 10,000 LB. TEST



PE6000

2" POLYESTER WEBBING

RATING: 6,000 LB. TEST



PE12000

2" POLYESTER WEBBING

RATING: 12,000 LB. TEST



PSBPVC-1WHT

WELDABLE POLYESTER
WEBBING

SIZE: 1", 2"



1353N

SURCINGLE, STAMPED STEEL

FINISH: NICKEL PLATE

SIZE: 1 1/2", 2"



3126N

3-3/4" CANOPY PIN

FINISH: NICKEL PLATE



DJ-5010-YZC

2" X 9.5MM DOUBLE J HOOK

RATING: 6,600 LB.

FINISH: YELLOW ZINC PLATE



WH35301

1-1/2" DOUBLE J HOOK

RATING: 6,000 LB.

FINISH: YELLOW ZINC PLATE



WH25151

1" DOUBLE J HOOK

RATING: 3,300 LB.

FINISH: YELLOW ZINC PLATE



2985WHI-Z

2" O RING, .37" WIRE,
WELDED

FINISH: WHITE ZINC



4N-1 1/2"

1 1/2" WELDED O RING .
235 WIRE DIAMETER

FINISH: NICKEL PLATE



JH-510ZP-1/4

1/4" WIRE ROPE, 7X19

FINISH: GALVANIZED



JH-510PVC-3/16

3/16" WIRE ROPE, 7X19,
GALVANIZED

FINISH: WHITE PVC COATED



BUCKLES



2348N
1/2" BUCKLE, ZINC DIE CAST
FINISH: NICKEL PLATE



2170N
3/4" BUCKLE, ZINC DIE CAST
FINISH: NICKEL PLATE



2177N
1" BUCKLE, ZINC DIE CAST
FINISH: NICKEL PLATE



2273N
5/8" BUCKLE, ZINC DIE CAST
FINISH: NICKEL PLATE



416N-Z-3/4
3/4" BUCKLE, ZINC DIE CAST
FINISH: NICKEL PLATE



40NSZ-1
1" BUCKLE, ZINC DIE CAST,
WITH LOOP LOCK
FINISH: NICKEL PLATE



210PL-B-1
1" CONWAY BUCKLE,
SOLID BRASS
FINISH: SELF COLOR



4430
SAM BROWNBUCKLE
MATERIAL: BRASS
FINISH:
NICKEL PLATE, POLISHED
SIZE: 2 1/4"



999N-1-1T
1" ROLLER BUCKLE, ONE
TONGUE WITH BARBS
FINISH: NICKEL PLATE



999N-1 1/2-1T
1 1/2" ROLLER BUCKLE, ONE
TONGUE WITH BARBS
FINISH: NICKEL PLATE



999N-2-1T
2" ROLLER BUCKLE, 1 TONGUE
WITH BARBS
FINISH: NICKEL PLATE



999N-3-2T
3" ROLLER BUCKLE, 2 TONGUE
WITH BARBS
FINISH: NICKEL PLATE



1353N-1 1/2
1.5" CIRCINGLE, STAMPED STEEL
FINISH: NICKEL PLATE
SIZES: 1 1/2", 2"



306 / 206A-3
SEAT BELT BUCKLE
COMBINATION STEEL & PLASTIC



STAMPINGS / BELT CLIPS



2629N
 3 1/4" X 7/8" BELT CLIP, RIVET HOLE
 FINISH: NICKEL PLATE



2537
 2 1/16" X 1" BELT CLIP, DOUBLE RIVET HOLE
 FINISH: NICKEL PLATE, BLACK RESIN



2888BLK
 1-1/4" X 2-5/8" CLIP
 FINISH: BLACK RESIN



2940SS
 7/8" X 2 1/4" BELT CLIP, STAINLESS STEEL
 FINISH: SELF COLOR



3134SS-R
 2" SLIDE, STAINLESS STEEL, NON SERRATED
 FINISH: SELF COLOR



3134SS-W
 2" SLIDE, STAINLESS STEEL, WIDE MOUTH
 FINISH: SELF COLOR



3134SS
 2" SLIDE, STAINLESS STEEL, SERRATED CENTER BAR
 FINISH: SELF COLOR



3137SS
 2" SLIDE, STAINLESS STEEL
 FINISH: SELF COLOR



RIVETS

SPLIT RIVETS & BAG STUDS

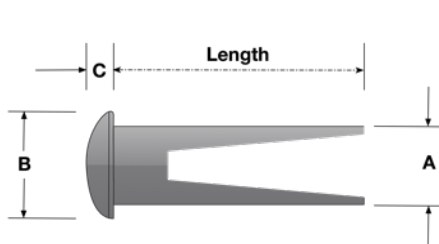

OVAL HEAD RIVET

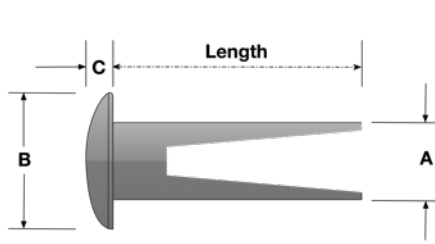

TRUSS HEAD SPLIT RIVET

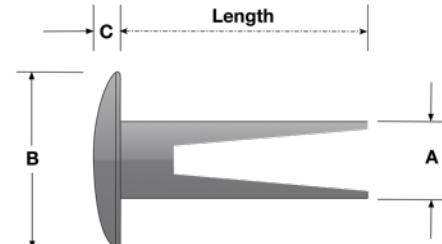

LARGE TRUSS HEAD SPLIT RIVET

Part #	Shank Dia.	Head Dia.	Min. Clinch Allowance
9A	1/8"	7/32"	1/8"
9	1/8"	5/16"	1/8"
8A	9/64"	3/8"	9/64"
8	9/64"	5/16"	9/64"
7A	5/32"	5/16"	5/32"
7	5/32"	3/8"	5/32"

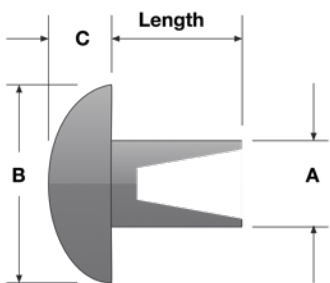

BAG STUD

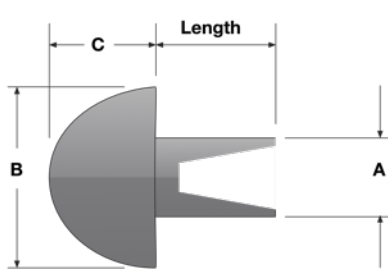

LARGE BAG STUD

Part #	Shank Dia. A	Head Dia. B	Head Height
2501	5/32"	.701"	5/16"
118	5/32"	.806"	5/16"
6491	5/32"	.825"	1/2"

TUBULAR (DEEP HOLE) RIVET

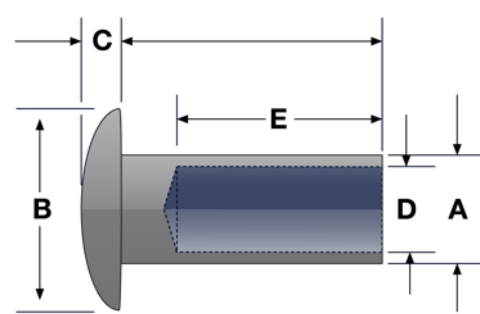
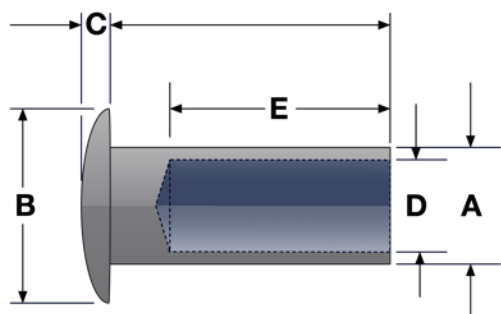

Dwg. 1

Oval Head

Dwg. 2

Truss Head

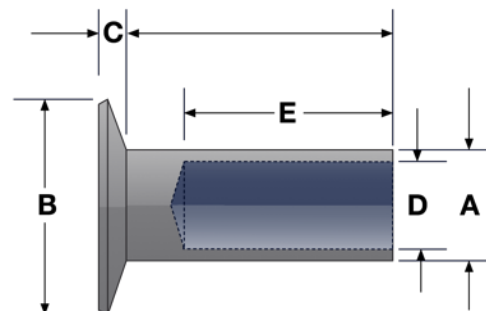
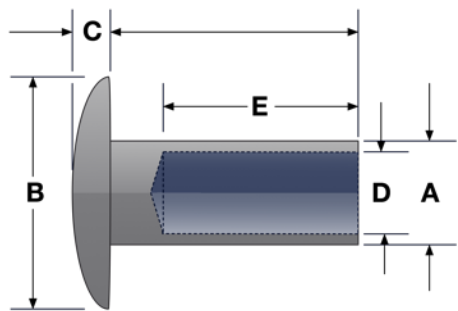

Dwg. 3

Large Truss Head

Dwg. 4

Flat Countersunk Head

Nom. Shank Dia.	Nom. Head Dia.	D W G	Rec. Hole Dia. in Assembly	Min. Clinch Allowance	Shank Dia. A	Head Dia. B	Head Thickness C	Hole Dia. D	Hole Depth E
1/8	7/32	1	0.128	0.093	.118 - .123	.213 - .223	.030 - .038	.087 - .090	.250 Max
9/64	1/4	1	0.152	0.125	.141 - .146	.240 - .250	.035 - .045	.095 - .098	.375 Max
9/64	9/32	2	0.152	0.125	.141 - .146	.276 - .286	.050 - .060	.095 - .098	.375 Max
9/64	5/16	2	0.152	0.125	.141 - .146	.306 - .318	.035 - .045	.095 - .098	.312 Max
3/16	3/8	2	0.191	0.156	.182 - .188	.369 - .381	.062 - .070	.134 - .141	.375 Max
9/64	3/8	3	0.152	0.125	.141 - .146	.369 - .381	.040 - .050	.095 - .098	.375 Max
9/64	3/8	4	0.152	0.125	.141 - .146	.369 - .381	.040 - .050	.095 - .098	.375 Max

• WHEN NOT SELF PIERCING
 ••TUBULAR (DEEP HOLE) RIVETS ARE NORMALLY SCORE CLINCHED WITH THESE ALLOWANCES. FOR ROLL CLINCH OF 1/8" DIA. USE .062", FOR 9/64". USE .093" AND FOR 3/16" DIA. USE .110"
 ALL SIZES ARE IN INCHES.

THESE AND OTHER SIZES ARE AVAILABLE.



HEAVY WEIGHT POLYESTER WEBBING

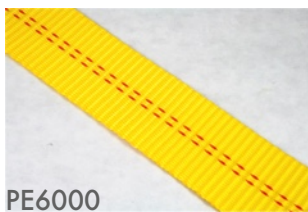

PE6000

2" POLYESTER WEBBING

RATING: 6,000 LB. TEST

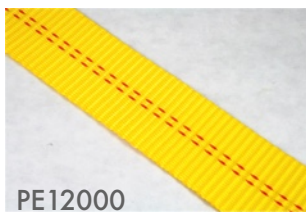

PE12000

2" POLYESTER WEBBING

RATING: 12,000 LB. TEST

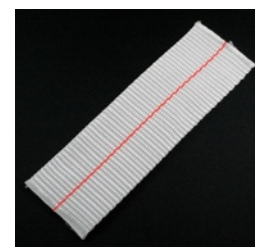

PE2-WHT-US

2" POLYESTER WEBBING

RATING: 10,000 LB. TEST



HEAVY & LIGHT WEIGHT POLYPROPYLENE WEBBING



COLORS:	SIZES:
RED	
BURGUNDY	1/2"
YELLOW	3/4"
GREEN	1"
BLUE	1 1/2"
TAN	2"
SILVER	3"
	4"



*OTHER COLORS AVAILABLE

*OTHER SIZES AVAILABLE



HOOK & LOOP

SEW-ON



PH

HOOK & LOOP
STANDARD PUT UP 25 YARDS PER ROLL
100% NYLON WOVEN
BLENDED POLYESTER
NYLON

BLACK & WHITE
OTHER COLORS AVAILABLE

SIZE: 1", 1 1/2", 2", 3", 4"



PRESSURE SENSITIVE

ITEM:
AAPH (AA = ADHESIVE ACRYLIC)
ARPH (AR = ADHESIVE RUBBER)

DESCRIPTION:
STANDARD RUBBER BASED ADHESIVE.
ACRYLIC BACKING AVAILABLE.
100% NYLON WOVEN
STANDARD PUT UP 27.5 YARDS PER ROLL
*FIRE RETARDANT ADHESIVE AVAILABLE.

COLOR: BLACK AND WHITE

FIRE RETARDANT

FIRE RETARDANT TREATMENT
RECOMMENDED FOR ANY PRODUCT REQUIRING FIRE PROTECTION

ITEM:
FRPH (FR = FIRE RETARDANT)

DESCRIPTION:
HOOK & LOOP
100% NYLON WOVEN
STANDARD PUT UP 27.5 YARDS PER ROLL

COLOR: BLACK AND WHITE

SIZES: 1", 1 1/2", 2"

BACK TO BACK

ITEM:
HLPH (HL = HOOK TO LOOP)
HHPH (HH = HOOK TO HOOK)
LLPH (LL = LOOP TO LOOP)
MLPH (ML = MUSHROOM TO KNITTED LOOP)
SVPH (SV = SOFT HOOK TO KNITTED LOOP)

DESCRIPTION:
HOOK & LOOP
100% NYLON WOVEN
STANDARD PUT UP 27.5 YARDS PER ROLL

COLOR: BLACK AND WHITE

SIZES: 1/2", 1", 1 1/2", 2"



COINS

ITEM:
CRPH (CR = COIN RUBBER)

DESCRIPTION:
HOOK & LOOP COINS
PRESSURE SENSITIVE KISS-CUT COINS WITH RUBBER-BASED ADHESIVE.
100% NYLON WOVEN
STANDARD PUT UP 25 YARDS PER ROLL

COLOR: BLACK AND WHITE

Width	1/2"	5/8"	3/4"	7/8"
Coins per Roll	1400	1320	1150	900
# of Rolls per CTN	60	50	40	40



SHEFFIELD CUTTING MACHINES

Sheffield Cutting Equipment is your one stop shop for all your strip cutting needs. Along with pioneering many innovations, including auto shut off, dual measuring systems and gear driven rollers, Sheffield was the first company to create and developed automatic hole punching and line marking machines.

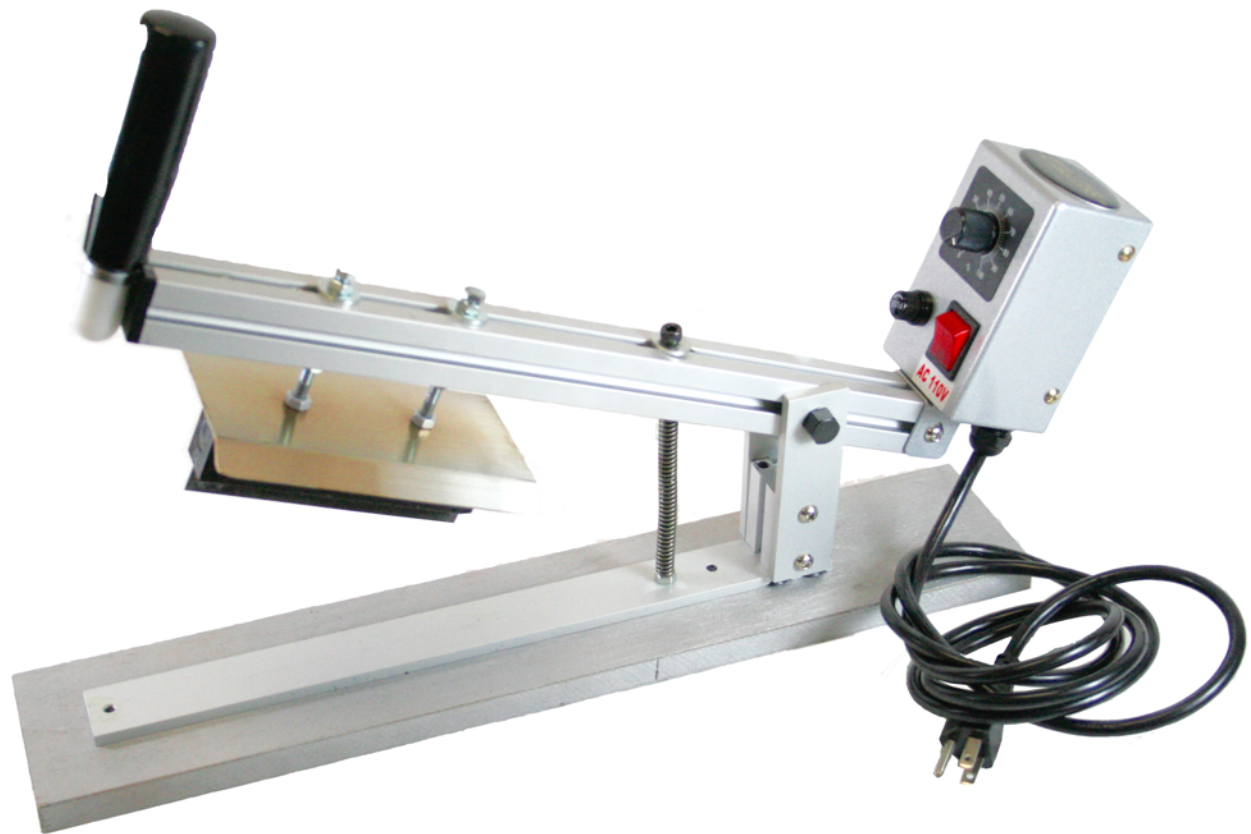

WITH OVER 80 DIFFERENT TYPES AND VARIATIONS OF CUTTING MACHINES, WE ARE CONFIDENT YOU WILL FIND THE RIGHT MACHINE FOR YOUR APPLICATION. HOWEVER, IF FOR ANY REASON YOU SHOULD NOT FIND EXACTLY WHAT YOU ARE LOOKING FOR, PLEASE CALL. VERY OFTEN WE DO MANUFACTURE, ONE OF A KIND MACHINES, MADE SPECIFICALLY TO FIT CUSTOMERS UNIQUE REQUIREMENTS.

UPON REQUEST WE WILL PROVIDE YOU INFORMATION ON A COLLECTION OF MACHINERY DESIGNED TO ACCOMPLISH THE TASK OF TRANSFORMING FLEXIBLE AND SEMI RIGID MATERIALS INTO CUT PIECES IN THE MOST EFFICIENT AND COST EFFECTIVE MANNER POSSIBLE.

IN ADDITION TO STOCKING OUR MOST POPULAR MACHINES WE ALSO KEEP INVENTORY OF REPLACEMENT PARTS FOR ALL OUR MACHINES.

FOR MORE INFORMATION PLEASE EMAIL OR GIVE US A CALL AND WE WILL BE HAPPY TO ADVISE YOU ON HOW TO BEST ACCOMPLISH ANY CUTTING TASK.

THANK YOU FOR CONSIDERING SHEFFIELD FOR YOUR CUTTING NEEDS. FOR YOUR CONVENIENCE WE HAVE INCLUDED WITHIN OUR WEB SITE A SAMPLING OF OUR MOST POPULAR MACHINES FOR YOUR REVIEW.

WITH OVER 80 DIFFERENT MODELS OF CUTTING MACHINES TO CHOOSE FROM WE ARE CERTAIN YOU WILL FIND THE RIGHT MACHINE FOR YOUR SPECIFIC NEED. AND WITH THE LONGEST GUARANTEE IN THE INDUSTRY YOU CAN BE CONFIDENT THAT YOU ARE PURCHASING THE BEST MACHINES AVAILABLE.

WHAT MAKES A SHEFFIELD STRIP CUTTER DIFFERENT FROM OTHER STRIP CUTTERS?

- ALL PARTS ARE GUARANTEED FOR 1 YEAR INCLUDING HEATING ELEMENTS AND KNIVES.
- ELECTRONICS ARE GUARANTEED FOR 2 YEARS.
- THE TOP AND BOTTOM ROLLERS ON OUR MACHINES ARE GEAR DRIVEN. THE ROLLERS ON OTHER STRIP CUTTERS STAY IN POSITION WITH SPRINGS, BECAUSE OF THIS EXCLUSIVE FEATURE THERE IS NO SLIPPAGE OF MATERIAL ON OUR MACHINES.
- THE TOLERANCE ON OUR MACHINES IS +/- .05% OF TOTAL CUT.
- ALL SHEFFIELD MACHINES HAVE ADJUSTABLE SPEED.
- SHEFFIELD MACHINES MEASURE IN INCHES AND MM.
- WE USE THE BEST STEPPING MOTORS AVAILABLE; (SANYO DENKI - MADE IN JAPAN).
- SHEFFIELD MACHINES ARE CE APPROVED.
- AUTO SHUT OFF: IF THE OPERATOR DOES NOT USE THE MACHINE WITHIN A PRESET TIME THE MACHINE WILL AUTOMATICALLY SHUT OFF THE POWER TO THE HEATING ELEMENTS. THIS UNIQUE SAFETY AND ENERGY SAVING FEATURE IS ONLY AVAILABLE ON SHEFFIELD MACHINES.
- OPTIONS: SHEFFIELD HAS OVER 80 DIFFERENT MODELS TO CHOOSE FROM, OUR COMPETITORS HAVE 3 OR 4 MODELS, INSTEAD OF FITTING YOUR REQUIREMENTS AROUND THEIR MACHINES. SHEFFIELD HAS A MACHINE TO FIT YOUR REQUIREMENTS.
- SHEFFIELD MACHINES ARE AVAILABLE FOR 2 WEEKS TRIAL.
- TRAINING AVAILABLE ON ALL CUSTOM MACHINES.





LOCATED JUST NORTH OF LOS ANGELES CA OFF THE 5 FRWY IN VALENCIA



P&H METAL PRODUCTS CORP.
28625 BRAXTON AVE • VALENCIA, CA 91355
PHONE: (661) 257-3977 | FAX (661) 257-0457
EMAIL: SALES@PHMETAL.COM | WEB WWW.PHMETAL.COM

WE ACCEPT:

